



530 JOHN L. DIETSCH BOULEVARD
NORTH ATTLEBORO, MA 02763

HR 100 SINGLE AXLE QUINT



PUMP, TANK AND HOSEBED WITH 100' REACH ON A SINGLE REAR AXLE.

The E-ONE HR 100 Single Axle Quint features a 100' vertical reach, 750-lb. tip load ladder with pump, tank and hosebed, all packaged on a single rear axle chassis. The crisscross under-slung outrigger system with a spread of only 11' allows the HR 100 Single Axle Quint to set up in tight locations, even to the front with all tires off the ground.

Once on scene the HR 100 Single Axle Quint is equipped to get the job done with a 1250-2000 GPM pump and 300 to 500 gallon water tank. The extruded aluminum body features tall, full-depth compartments on each side, a center tunnel holding 127' of ground ladders and a SideStacker™ hosebed that can be re-loaded without raising the aerial.

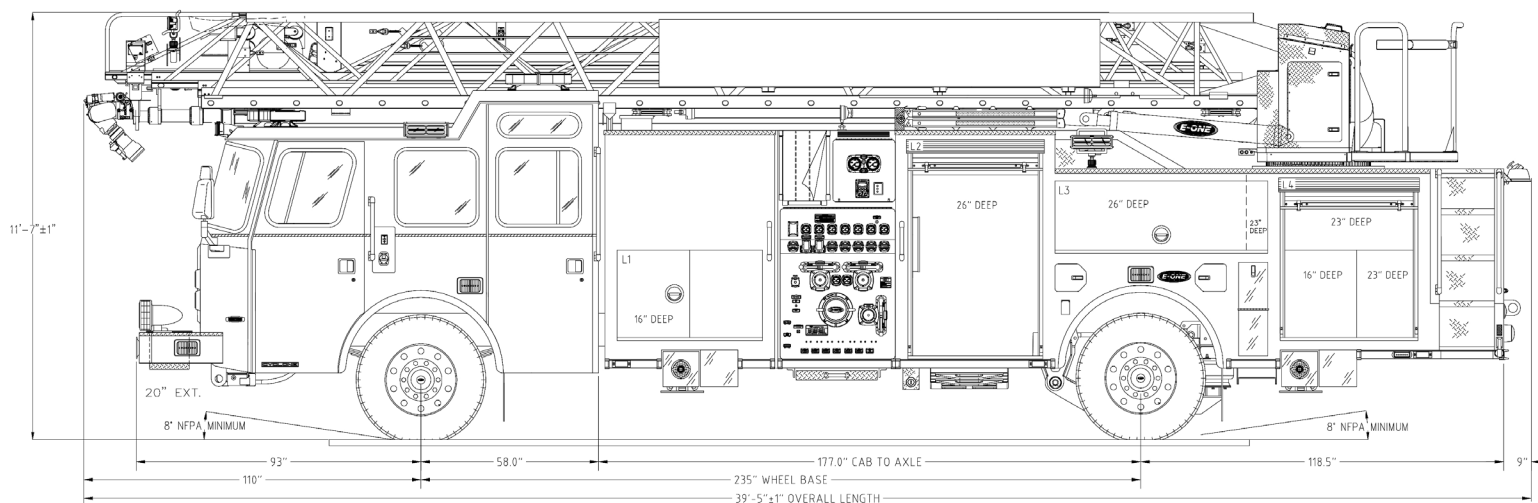

CUSTOM CHASSIS

- Typhoon® or Cyclone® chassis
- Medium length 4-door cab (long cab optional)
- Integral torque box frame
- 235" wheelbase
- 24,000-lb. front axle
- 35,000-lb. rear axle
- Cummins® L9 450 HP or X12 500 HP engine
- Standard safety features include roll cage cab construction, Crewguard™ and ABS brakes
- Options include split-raised roof, medical cabinets, severe-duty bumper and interior, airbags, and G4 (electronic stability control)

AERIAL FEATURES

- 100' ToughTruss® welded extruded aluminum ladder with 2.5 to 1 structural safety factor
- 825 lb. tip load dry (750 lbs. firefighters and 75 lbs. equipment) ; 575 lbs. tip load wet (500 lbs. firefighters and 75 lbs. equipment)
- 85' horizontal reach
- Crisscross under-slung jacks with only 11' spread
- Waterway to tip (pinnable at end of section 3 for rescue work)
- Smooth operating Advanced Aerial Control System with 3.2" or optional 7" display
- Options include extended range monitor, 2.5 valve at tip, pump panel and wireless aerial controls, and brackets for a roof ladder, axe and pike pole
- Other aerial models available with this chassis/ body configuration include the 110' ladder for additional vertical reach and the LTH 100 for a 4" reduction in travel height

BODY

- Extruded aluminum construction
- Raised rear body for increased departure angle
- Left and right full height rescue style compartments
- Wide turntable access staircase
- SideStacker™ hosebed that can be reloaded without raising the ladder
- Enclosed tunnel for 127' of ground ladders
- Options include extended length hosebed, roll-up doors, shelves, trays, toolboards, and diamond plate hosebed cover

FIRE PACKAGE

- Pumps up to 2,000 GPM
- Up to 500-gallon water tank
- Stainless steel discharge manifold
- Customizable discharges and pre-connects
- Optional direct injection foam system

ELECTRICAL

- Multiplex electrical system with optional color display provides increased feature capability and improved diagnostics
- LED warning light packages
- Options include LED scene lights, LED ladder climbing lights and 6 to 15 kW hydraulic generators